

EWN.SST

Wing nuts

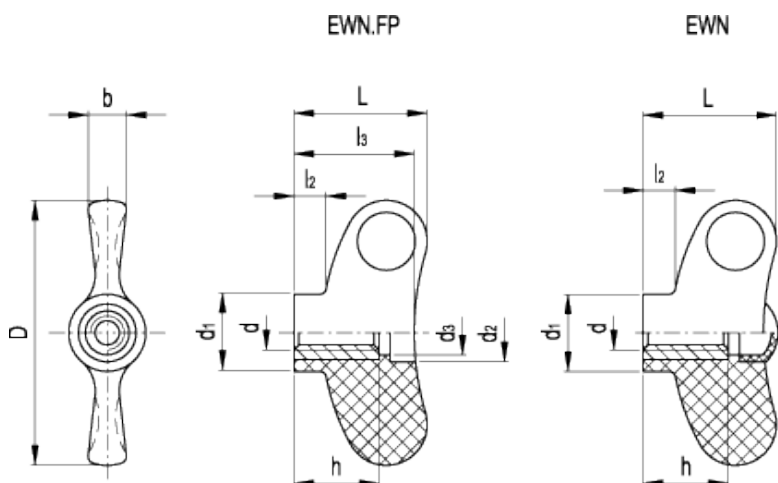

ELESA Original design



technical informations

Material

Glass-fibre reinforced polyamide based (PA) technopolymer. Resistant to solvents, oils, greases and other chemical agents.

Colour

Grey-black, matte finish.

Assembly

- EWN.SST-FP: AISI 303 stainless steel boss, tapped through hole, without cap.
- EWN.SST: AISI 303 stainless steel boss, tapped through hole, with cap.

Cap for EWN.SST

Technopolymer in Ergostyle colours, matte finish; supplied assembled, press-fit assembly, removable by a screwdriver. Available also as accessory sold separately (see caps table).

Features and applications

AISI 303 stainless steel, thanks to its high resistance to corrosion, allows the application of these wing nuts on machines and equipment in those sectors where laws or particular hygienic, climatic and environmental factors make it mandatory to use corrosion resistant materials.

Ergonomy and design

The slightly concave marks on the wings help to position the fingers in order to apply the maximum force when tightening.

C1 RAL 7021 **C2 RAL 2004** **C3 RAL 7035** **C4 RAL 1021** **C5 RAL 5024** **C6 RAL 3000**

Standard Elements		Main dimensions									Mounting hole		C #	Weight
Code	Description	D	L	d ₁	l ₂	b	d ₂	d ₃	l ₃	d _{6H}	h	[Nm]	g	
224122-C0	EWN.48 SST-FP-M6-C0	47	24	13.5	5.5	7	10	8.5	21.5	M6	12	-	9	
224123-C0	EWN.48 SST-FP-M8-C0	47	24	13.5	5.5	7	10	8.5	21.5	M8	12	-	8	
224133-C0	EWN.55 SST-FP-M8-C0	55	28	16	6.5	8	12	10.5	25	M8	18	-	18	
224153-C0	EWN.70 SST-FP-M10-C0	70	36	20	8	10	15	13	32	M10	20	-	31	
224216-*	EWN.48 SST-M6-*	47	24	13.5	5.5	7	-	-	-	M6	12	10	10	
224221-*	EWN.48 SST-M8-*	47	24	13.5	5.5	7	-	-	-	M8	12	10	9	
224241-*	EWN.55 SST-M8-*	55	28	16	6.5	8	-	-	-	M8	18	15	19	
224411-*	EWN.70 SST-M10-*	70	36	20	8	10	-	-	-	M10	20	35	33	

* Complete the code and the description of the standard item needed by adding the index of the colour of the cap (C1,...,C6) ex: 224216-C2 EWN.48 SST-M6-C2# "Max limit Tightening torque" means the max torque value at which the metal insert, in normal conditions of use, is perfectly and strongly anchored to the plastic material.

Code	Description	Abdeckkappe für
29752-*	ECA.W2-*	EWN.48
29753-*	ECA.W3-*	EWN.55
29754-*	ECA.W4-*	EWN.70

* Complete the code and the description by adding the index of the colour (C1,...,C6).

This product had the following design awards:

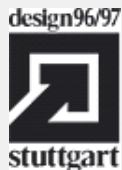

ELESA and GANTER models all rights reserved in accordance with the law. Always mention the source when reproducing our drawings.

STANDARD MACHINE ELEMENTS WORLDWIDE